

VETROTECH  
FIRE RESISTANCE

Saint-Gobain  
Glass Solutions



# SGG SWISSFLAM® LITE SFL60-N2

Fire-test Certification Summary

*Partially Insulating Clear  
Fire Resisting Glass*

*Multi-Panel Steel Screen / Partition  
67 Minutes Integrity  
7 Minutes Insulation*

*Test Institute: TNO/Warrington Fire  
Research Centre*

*Test Number: TNO 2002-CVB-R04862  
and WFRC 123542/A*

*Test Standard: EN 1364-1:1999*

*Test Sponsor: Vetrotech Saint-Gobain  
International AG*

**SAINT-GOBAIN GLASS PROTECT**

## SGG SWISSFLAM® LITE SFL60-N2

**Test Institute:** TNO and Warrington Fire Research Centre

**Test Number:** (TNO 2002-CVB-R04862) and (WFRC 123542/A Approved Document B)

**Test Date:** 2 October 2001

**Test Standard:** EN 1364-1:1999

**Test Sponsor:** Vetrotech Saint-Gobain International AG

**Test Result:** 67 minutes integrity  
7 minutes insulation

**Summary:** A multi-panel glazed steel screen of overall dimensions of 2960mm x 2960mm, incorporating a full height mullion and three transom members. Glazed with 5 no. panes of 13mm thick *see* SWISSFLAM LITE SFL60-N2 partially insulating clear fire resisting glass, retained within the frame by mild steel glazing beads, which, were snap fitted over glazing studs fixed to the framing members on the exposed face. Subjected to a test in accordance with EN 1364-1 for a separating element, to 67 minutes integrity and 7 minutes insulation (EW60).

### Elevation

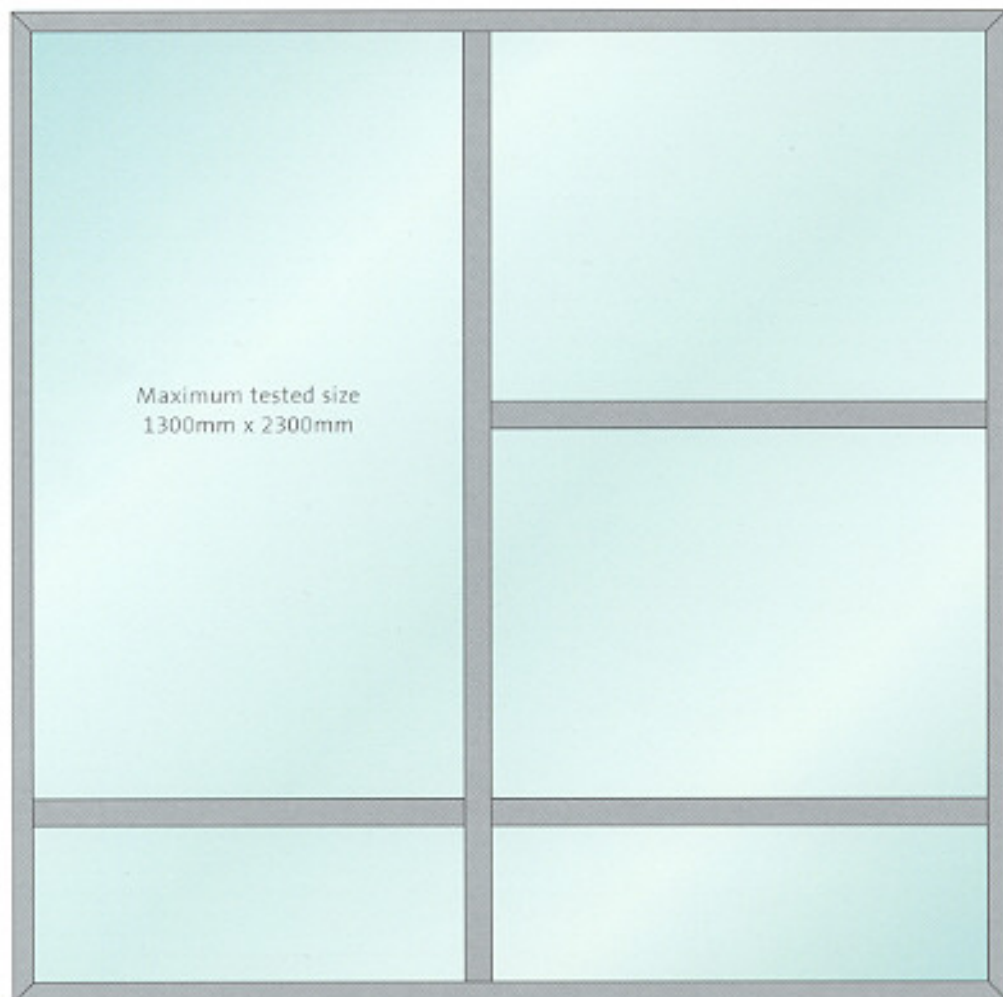

# SGG SWISSFLAM® LITE SFL60-N2

## Section

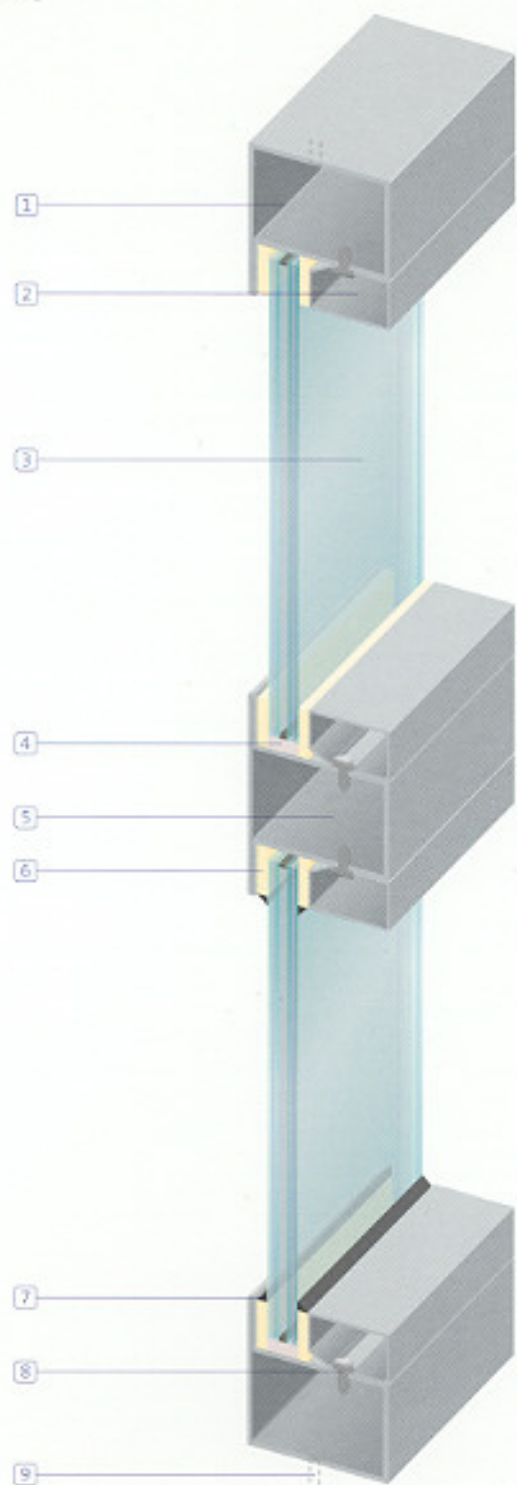

## Parts List

1. Jansen Economy 60, mild steel profiles, perimeter section 60mm x 60mm
2. Jansen Economy 60 snap-on glazing beads 35mm x 20mm
3. SGG SWISSFLAM LITE SFL60-N2 partially insulating clear fire resisting glass
4. Non-combustible setting blocks 80mm x 14mm x 5mm
5. Jansen Economy 60 mild steel profiles, transom / mullion section 60mm x 80mm
6. Kerafix 2000 ceramic glazing tape 20mm x 4mm (compressed to 2mm)
7. Silicone capping (optional)
8. Jansen glazing studs
9. M10 x 70mm steel screws into plastic plugs

# SGG SWISSFLAM® LITE SFL60-N2

## Construction

The perimeter frame was made from Jansen Economy 60 mild steel profiles with section dimensions of 60mm x 60mm, including a 20mm glazing up-stand. The transoms and mullions were of the same system type and had section dimensions of 60mm x 80mm. The perimeter frame was fixed using steel screws M10 x 70mm long into plastic plugs. The frames were glazed with 13mm thick SGG SWISSFLAM LITE SFL60-N2 partially insulating clear fire resisting glass, supported on 'Flammi' setting blocks 80mm x 14mm x 5mm, 2 no. per glass pane. Between the face of the glass and the glazing bead, Kerafix 2000 ceramic paper tape 20mm x 4mm (compressed to 2mm) was fitted. The glass was retained by snap-on glazing beads 35mm x 20mm over steel glazing studs at 300mm centres and 70mm in from each end.

## Performance

The specimen satisfied the performance requirements specified in Clause 11 of EN 1364-1, for a separating element, for the following period:

Integrity: 67 minutes  
Insulation: 7 minutes

## Glazing

1300mm wide x 2300mm high  
1300mm wide x 490mm high  
1490mm wide x 1120mm high  
1490mm wide x 1120mm high  
(Nominal edge clearance 5mm /  
Edge cover 15mm ±2mm)

## Safety

SGG SWISSFLAM LITE SFL60-N2 partially insulating clear fire resisting glass is a Class A safety glazing material, in accordance with BS 6206:1981.

## Product description

SGG SWISSFLAM LITE SFL60-N2 is a partially insulating clear fire resisting glass. Produced from high performance laminated safety glass incorporating an advanced intumescent interlayer, which when exposed to fire turns opaque to form a partially insulating barrier to heat, smoke and flames. For use in doors and partitions of steel or timber construction, for 60 minutes integrity and radiated heat control (EW60) fire resisting applications.

## Installation

SGG SWISSFLAM LITE SFL60-N2 should be glazed in accordance with our recommendations to ensure full compliance with the relevant fire-test certification. Each panel must be ordered to the correct size and shape, as the product cannot be cut down on site, after manufacture. Any subsequent alterations required to size or shape can only be carried out at an authorised cutting station or approved stockist. As part of the production process, SGG SWISSFLAM LITE SFL60-N2 has a special metallic protection tape applied to the glass edges. This must not be removed under any circumstances. The glass should not be glazed in a manner which would allow water to be trapped in the glazing channel as this may contaminate the intumescent interlayers. Once installed the glass should be immediately capped off with a suitable silicone.

## Storage and handling

When handling SGG SWISSFLAM LITE SFL60-N2, particular care should be taken to avoid mechanical damage to the glass edges. Abrasions to glass panels which result in damage to the protective edge tape should be avoided, as the intumescent interlayer may be contaminated. Such panels should be inspected and replaced as necessary. SGG SWISSFLAM LITE SFL60-N2 should be stored in a dry environment. The glass edges should be supported on timber battens or other non-abrasive materials and stacked upright. During storage, the glass should not be exposed to temperatures likely to exceed or fall below +45°C / -10°C.

## Maintenance

SGG SWISSFLAM LITE SFL60-N2 glass requires no special maintenance procedures. Once installed the glass should be cleaned regularly using warm water and a liquid detergent, washed down with clean water. Damaged or broken panels should be replaced, as this could affect the fire performance capabilities of the product.

## Technical advice

A Technical Advice Service is in daily operation at Vetrotech Saint-Gobain U.K. Ltd, where comprehensive information can be obtained on the correct use and application of the wide range of fire resisting glass products available.

If you would like more information or help, please call Vetrotech Saint-Gobain on 0113 239 1500 or contact us by email on [infovsguk@vetrotech.co.uk](mailto:infovsguk@vetrotech.co.uk)

Represented by

SAINT-GOBAIN  
GLASS

VETROTECH  
FIRE INSULATION  
Saint-Gobain  
Glass Solutions